

Chy 5 Ref: 13-9 Schedule 13 - Temporary Sign	ROAD AHEAD CLOSED ACCESS ONLY	
Chy 2 Ref: 2702 End of temporary diversion route	DIVERSION ENDS	
Chy 1 Ref: 2702 Start of temporary diversion route	DIVERSION	
Chy 3 Ref: 2703 Direction of temporary diversion route from junction ahead	DIVERTED TRAFFIC	
Chy 3 Ref: 2703 Direction of temporary diversion route from junction ahead	DIVERTED TRAFFIC	
Chy 3 Ref: 7001 Road works ahead		

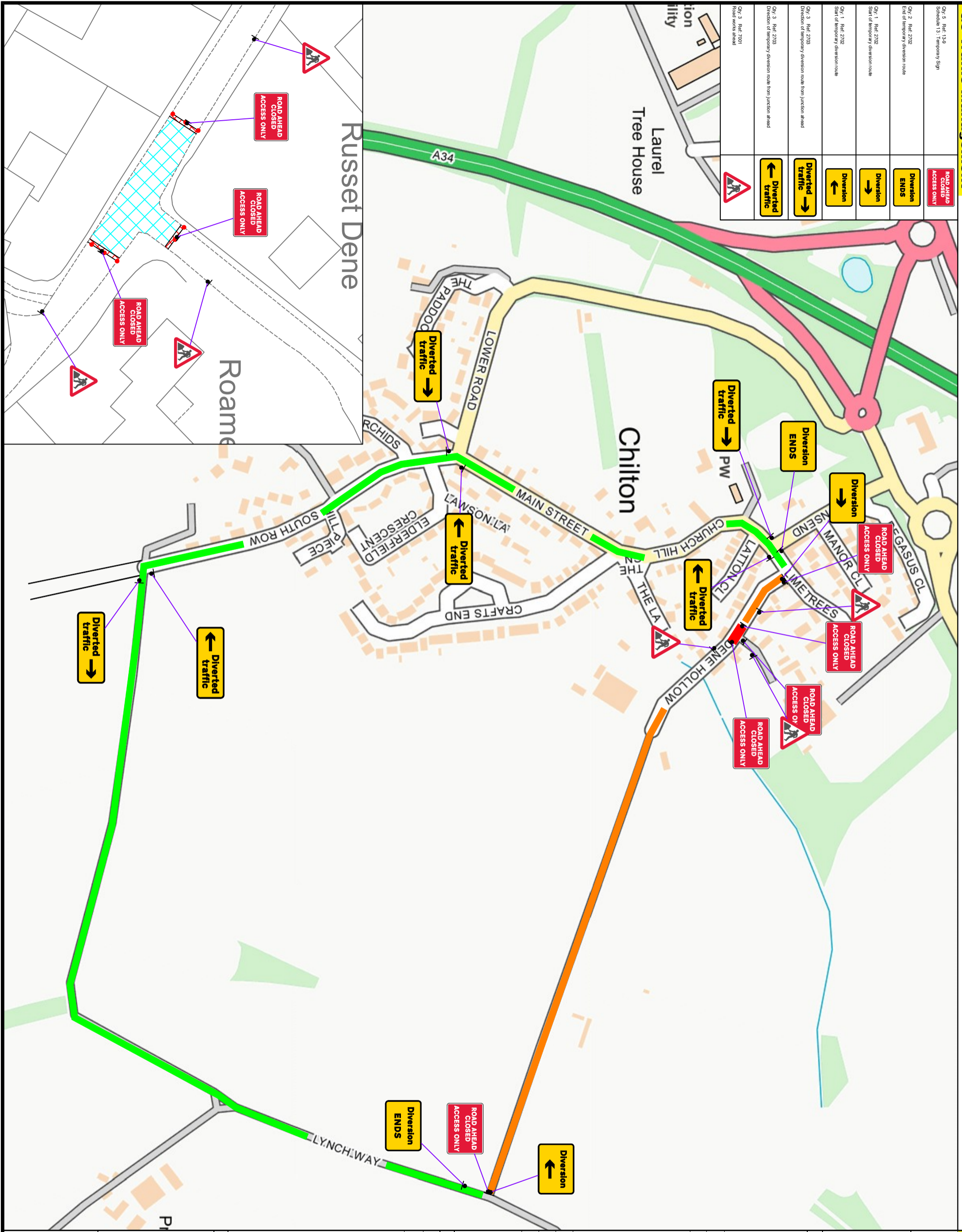

NOTES

- All signs are per Chapter 6, Schedule 13 unless stated to be the maximum number otherwise stated.
- All signs must be used in pairs on all road work - a 'road sign' or 'closure' sign.
- All signs must be used in pairs on all road work - a 'road sign' or 'closure' sign.
- All signs must be used in pairs on all road work - a 'road sign' or 'closure' sign.
- All signs must be used in pairs on all road work - a 'road sign' or 'closure' sign.
- All signs must be used in pairs on all road work - a 'road sign' or 'closure' sign.
- All signs must be used in pairs on all road work - a 'road sign' or 'closure' sign.
- All signs must be used in pairs on all road work - a 'road sign' or 'closure' sign.
- All signs must be used in pairs on all road work - a 'road sign' or 'closure' sign.
- All signs must be used in pairs on all road work - a 'road sign' or 'closure' sign.

CLIENT:

DRAWING NUMBER: 1619392.001 RC
WORK ORDER NUMBER: 81440519
DRAWING ADDRESS:
 Lime Tree Farm, Dene Hollow, Chilton, Didcot,
 Oxfordshire, OX11 0SP

DESIGNED DATE: 22/12/2025
DESIGNED BY: Haydn Bamsey
APPROVED BY: Alex Hunnabale

DRAWING INFORMATION:
TRAFFIC MANAGEMENT TYPE:
 ROAD CLOSURE

**ROAD CLOSED FOR APPROX 20M,
 85M SOUTHEAST OF DEAN
 HOLLOW JCT WITH CHURCH HILL.**
DIVERSION VIA:
 LYNCH WAY,
 SOUTH ROW,
 MAIN STREET,
 CHURCH HILL

KEY:

	Sign		Ped Diversion
	Cone		Parking Bay Suspension
	Temporary Traffic Light		Ped Ramp
	Temporary Prohibitive Sign		Road Closure
	Sign - Co Bats		Diversion Route
	Sign - Co Bats		Access Only
	Ped Barriers		Working Space
			Wide Area
			Safety Zone